

LD34-C1

High Powered Linear In-ground LED Wall Grazer



Install sheet - Page 1

SPECIFICATION

LED recessed luminaires are class III for Safety Extra Low Voltage **DC** supply. The product should only be used with a supplied or LightGraphix approved **350mA**, **500mA** or **700mA** constant current driver.

Lamp: **C1 LED Engine**.
This fitting is **IP67** rated.
Lumen Maintenance: L90B5 at 90,000hrs.

LD34 - C1	
Product & LED Output Code	Power Output
LD34-C1 - 350	350mA 1.2W (Per LED)
LD34-C1 - 500	500mA 1.7W (Per LED)
LD34-C1 - 700	700mA 2.4W (Per LED)

/SC
Spring Clips

/CH
Concrete Housing

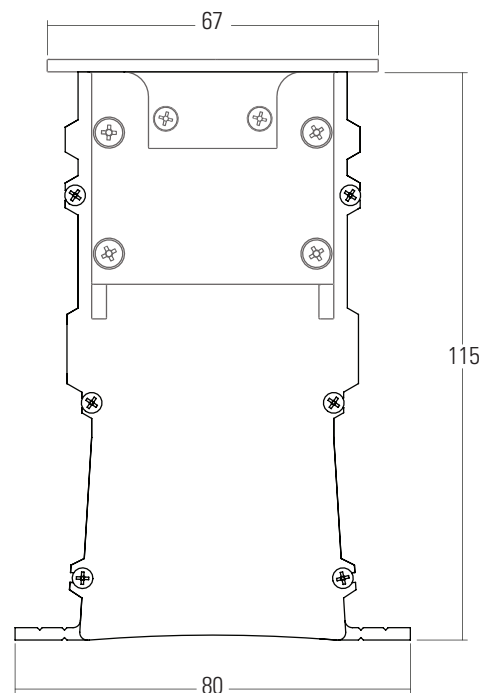
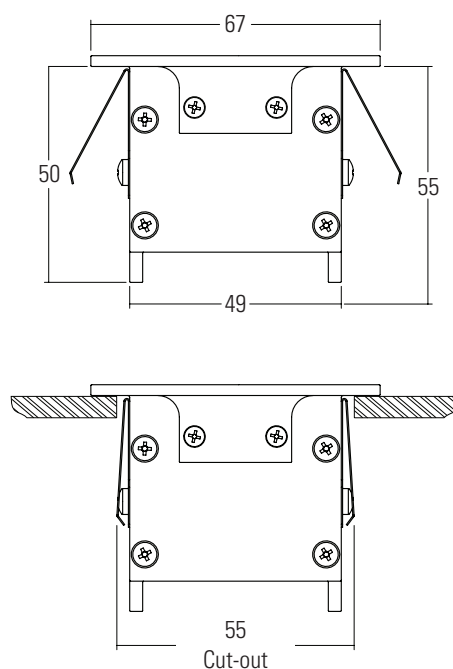
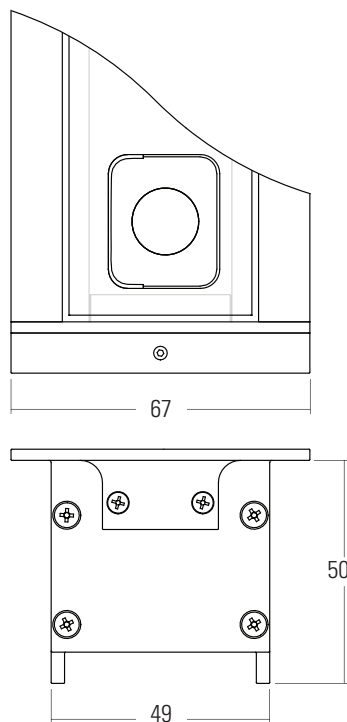

SEE CONSTANT CURRENT WIRING SHEET FOR IN SERIES WIRING DIAGRAM

WIRING

Do not power up until fitting is wired correctly! Constant current LEDs must be wired in series, polarity is critical. Please refer to specified driver sheet for details on the minimum and maximum number of LEDs per circuit.

CORE COLOUR & POLARITY								
Circuit	1	2	3	4				
Colour of Cable	Red	Black	Green	Yellow	Blue	White	Brown	Purple
Materials	+	-	+	-	+	-	+	-

IMPORTANT

Make sure that all cables and connections are securely connected before switching on the power. Failing to do this can lead to failure of the LEDs and/or the driver. If the LEDs do not work upon power up, turn off the power source immediately and check the polarity of the wiring. Any attempt made to open up and/or modify the luminaire will invalidate the manufacturers warranty. This is inclusive of but not limited to removal of the LightGraphix product label or removal of any parts from the main body of the product including bezels, electrical components and factory fitted fixing methods (unless otherwise stated in these instructions).

MAINTENANCE

Clean with soft damp cloth.
LED: Please contact LightGraphix.

LD34-C1/SC

In-Ground LED Uplighter



Install sheet - Page 2

SPRING CLIPS INSTALLATION

- 1 Prepare cut out: 55mm (w) x product run length - 10mm (example below). When used in exterior application, the drainage test detailed in section 1 of the concrete housing installation (Page 3 of this guide) will need to be performed.

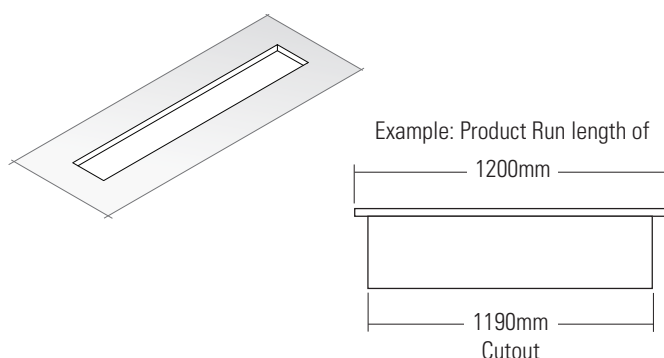

- 3 Feed cable through to the drivers location. Connect luminaire to specified driver, ensuring it is disconnected on the mains side.

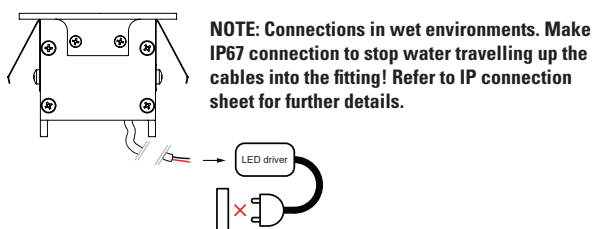

- 5 Compress spring clips into body and insert the fitting into the cutout.

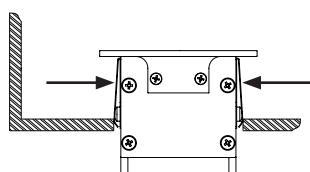

- 2 In-Line: If product is to be installed in-line the flange will be supplied separately. Use the screws provided to attach them to the outside of the in-line length.

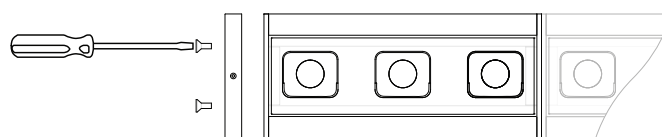

- 4 In-Line: Ensure the fitting is correctly orientated using the indicator sticker.

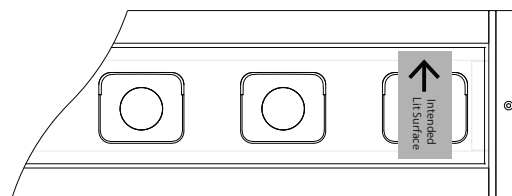

- 6 Ensure the fitting is correctly orientated using the indicator sticker.

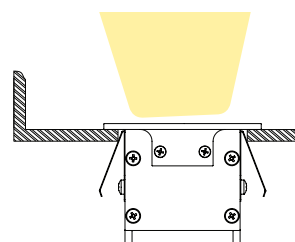

LD34-C1/CH

In-Ground LED Uplighter



Install sheet - Page 3

CONCRETE HOUSING INSTALLATION

- 1 Ground preparation. Regardless of the mounting surface the area must have adequate drainage. A volume of water equal to the volume of the mounting channel must drain away within 30 minutes.

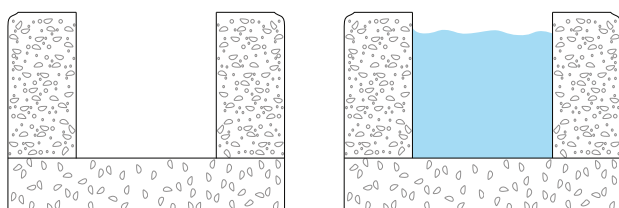

- 2 Drill drainage holes (4 per metre) using the guide grooves on the base of the concrete housing. Also using the template provided prepare the end caps for a gland or conduit (to be supplied by others).

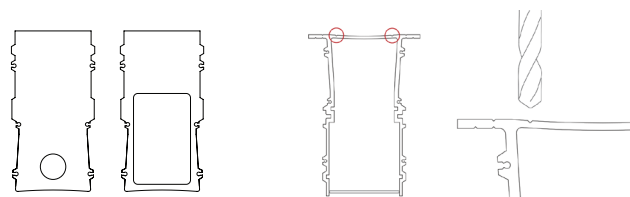

Match the label on the concrete housing to the specification on the delivery note.

- 3 Single - Assemble the concrete housing using the screws provided.

Note: The tearout strip must be left in until steps 6 and 7.

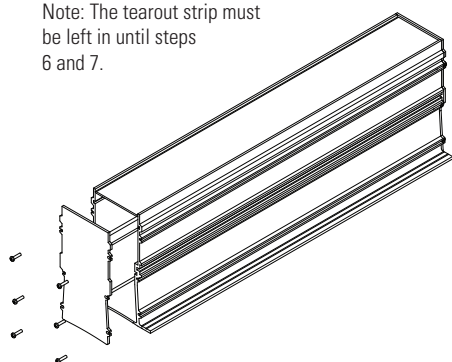

Multiple - Use the connection kit provided. The two sections must be secured with no gaps.

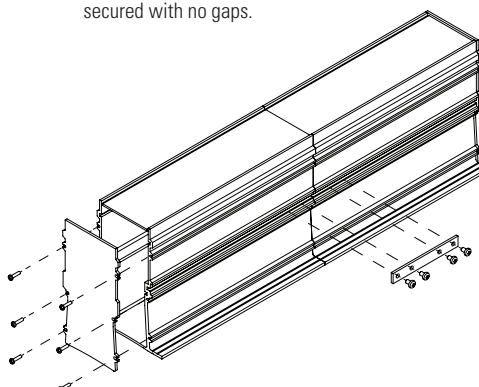

In-Line: If product is to be installed in-line the flange will be supplied separately. Use the screws provided to attach them to the outside of the in-line length.

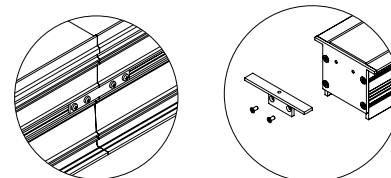

- 4 Place the concrete housing in the prepared channel, this must be level. If the housing requires bolster, ensure it is supported along its entire length and that its drainage ability is not compromised.

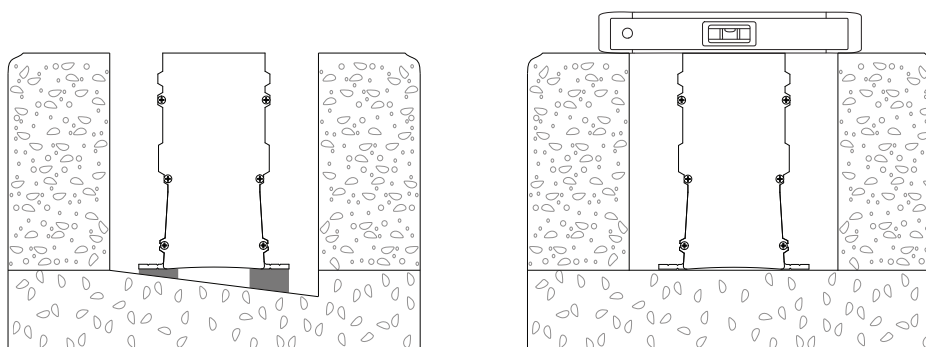

LD34-C1/CH

In-Ground LED Uplighter



Install sheet - Page 4

CONCRETE HOUSING INSTALLATION

- 5** If a secondary surface is going to be used ensure the concrete is offset by the specified material thickness.

If a secondary surface is not a solid substrate this must not be walked over. For it to be used in a walk over environment, the flanged bezel must be supported by a solid substrate.

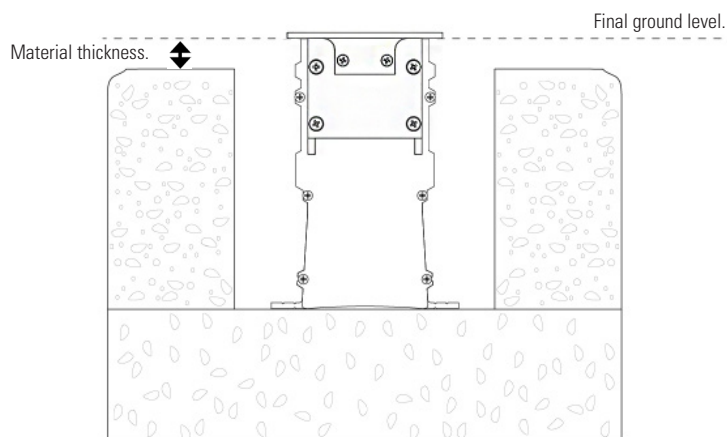

- 6** Once placement has been confirmed secure the housing using the flanged base.

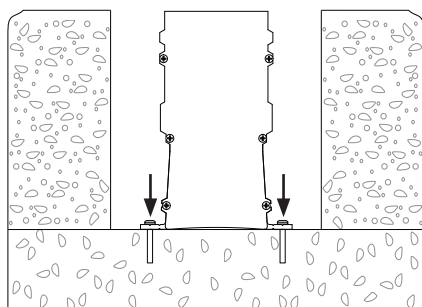

- 7** Fill remaining cavity with concrete.

When pouring ensure as little material falls into the channel as possible.

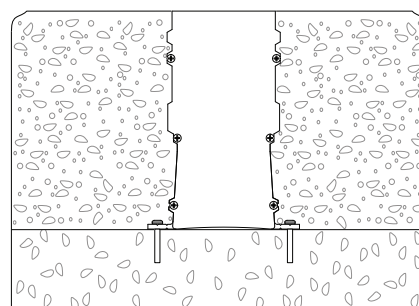

LD34-C1/CH

In-Ground LED Uplighter



Install sheet - Page 5

CONCRETE HOUSING INSTALLATION

- 8** Before removing the concrete housing tear strip. Check the reference label on the concrete housing and match it to the fitting.

Check the delivery note or drawing (if supplied) for product configuration and location.

- 10** To remove the strip place an allen in the chuck of a drill and use it to peel the tear-out strip away from the housing.

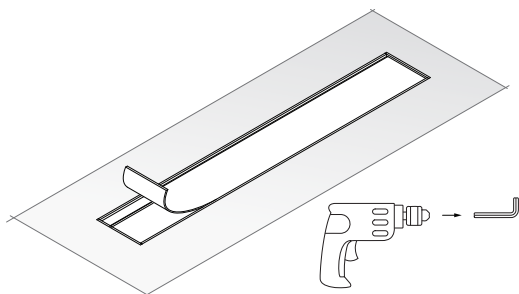

- 12** Ensure the fitting is correctly orientated using the indicator sticker.

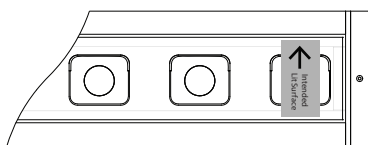

NOTE: Connections in wet environments. Make IP67 connection to stop water travelling up the cables into the fitting! Refer to IP connection sheet for further details.



- 9** Once the concrete has set the tear-out strip can be removed. Drill a hole through the centre of the tear-out strip roughly 40mm from the end of the length.

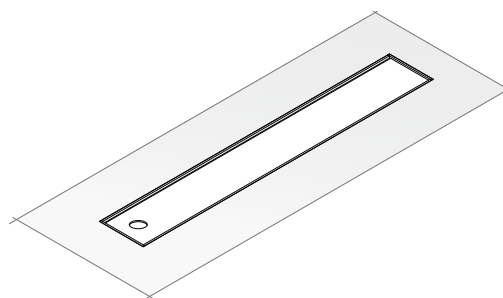

- 11** Feed cable through to the drivers location. Connect luminaire to specified driver, ensuring it is disconnected on the mains side.

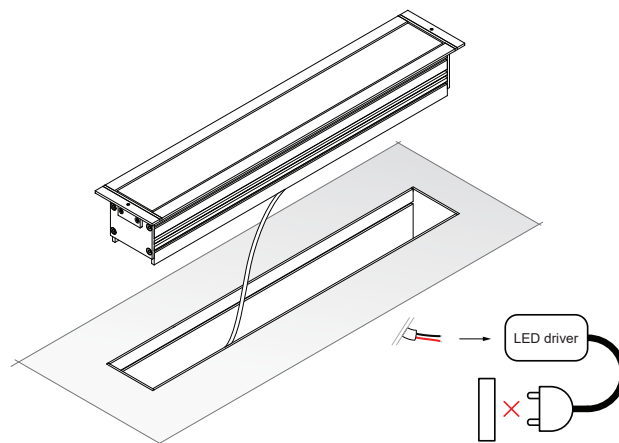

- 13**

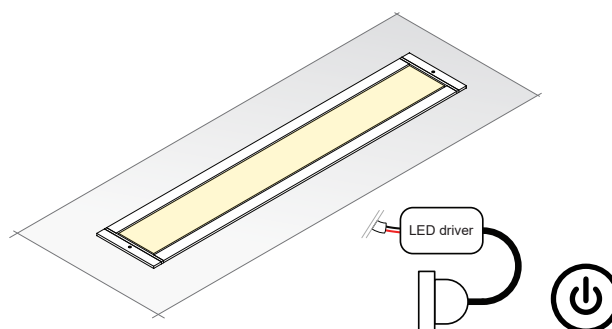

LD34-C1/CH

In-Ground LED Uplighter



Install sheet - Page 6

END CAP TEMPLATE



Ensure the holes drilled for glands or conduits remain within the area highlighted below. Cut around dotted lines and lay over the end cap, the outer edge of the drill must stay in this zone.

